

DESIGN DESIGNATION

A.D.T. - 2008 = 6030
 A.D.T. - 2028 = 8860
 D.H.V. = 7%
 T = 24%
 V = 60 M.P.H.

FUNCTIONAL CLASSIFICATION = PRINCIPAL ARTERIAL

CONTROLLED ACCESS HIGHWAY

THIS SHALL BE A CONTROLLED ACCESS HIGHWAY, BETWEEN STA. 741+75.91 AND 1208+18.27 EXCEPT AT LOCATIONS AND AS OTHERWISE SPECIFICALLY SHOWN ON THESE PLANS. NO ABUTTER'S RIGHTS IN OR OF DIRECT ACCESS TO, FROM, OR ACROSS THE HIGHWAY OR ITS RIGHT-OF-WAY SHALL ATTACH OR BELONG TO ANY PROPERTY ABUTTING ON SAID SECTION OF HIGHWAY, OR TO ANY PERSON MERELY BECAUSE OF OWNERSHIP OF SUCH ABUTTING PROPERTY. THERE SHALL BE THE USUAL RIGHT OF ACCESS OVER ANY LOCATION SHOWN ON THESE PLANS EITHER AS (1) AN ENTRANCE OR (2) A PRIVATE UNDERPASS, WHEREVER AN ADJACENT OUTER ROADWAY OR SERVICE ROAD IS SHOWN. THERE SHALL BE THE USUAL RIGHT OF DIRECT ACCESS BETWEEN THE ABUTTING PROPERTY AND SUCH OUTER ROADWAY OR SERVICE ROAD EXCEPT WHERE ACCESS IS SPECIFICALLY PROHIBITED BY THE SPECIAL SYMBOL (DENOTING NO RIGHT OF ACCESS) AND ALONG IT TO AND FROM THE NEAREST LANE OF THE THROUGHWAY OF A PUBLIC HIGHWAY. OUTER ROADWAYS AND SERVICE ROADS, AS THE CASE MAY BE, ARE SO DESIGNATED ON THE PLANS.

- BEGINNING AND ENDING OF CONTROLLED ACCESS
- CONTROLLED ACCESS
- NO RIGHT OF ACCESS OR CROSSING OF LINES BEARING THIS SYMBOL WILL BE PERMITTED UNDER ANY CIRCUMSTANCES.

CONVENTIONAL SYMBOLS

(USED IN PLANS)

- | EXISTING | NEW |
|------------------|-----|
| | |
| | |
| | |
| | |
| | |
| UTILITIES | |
| | |
| | |
| | |
| | |
| | |
| | |
| | |
| MANHOLE | |
| | |
| | |
| | |
| | |
| | |
| | |
| | |
| | |
| | |
| | |
| | |
| | |
| | |
| | |

NOTE: DASHED OR OPEN SYMBOLS INDICATE EXISTING FEATURES

**MISSOURI HIGHWAYS AND TRANSPORTATION COMMISSION
 PLANS FOR PROPOSED
 STATE HIGHWAY**

HOWELL COUNTY

PROPOSED PROJECT LIMITS
 GRADING, DRAINAGE, BRIDGE, PAVING,
 AND RIGHT-OF-WAY

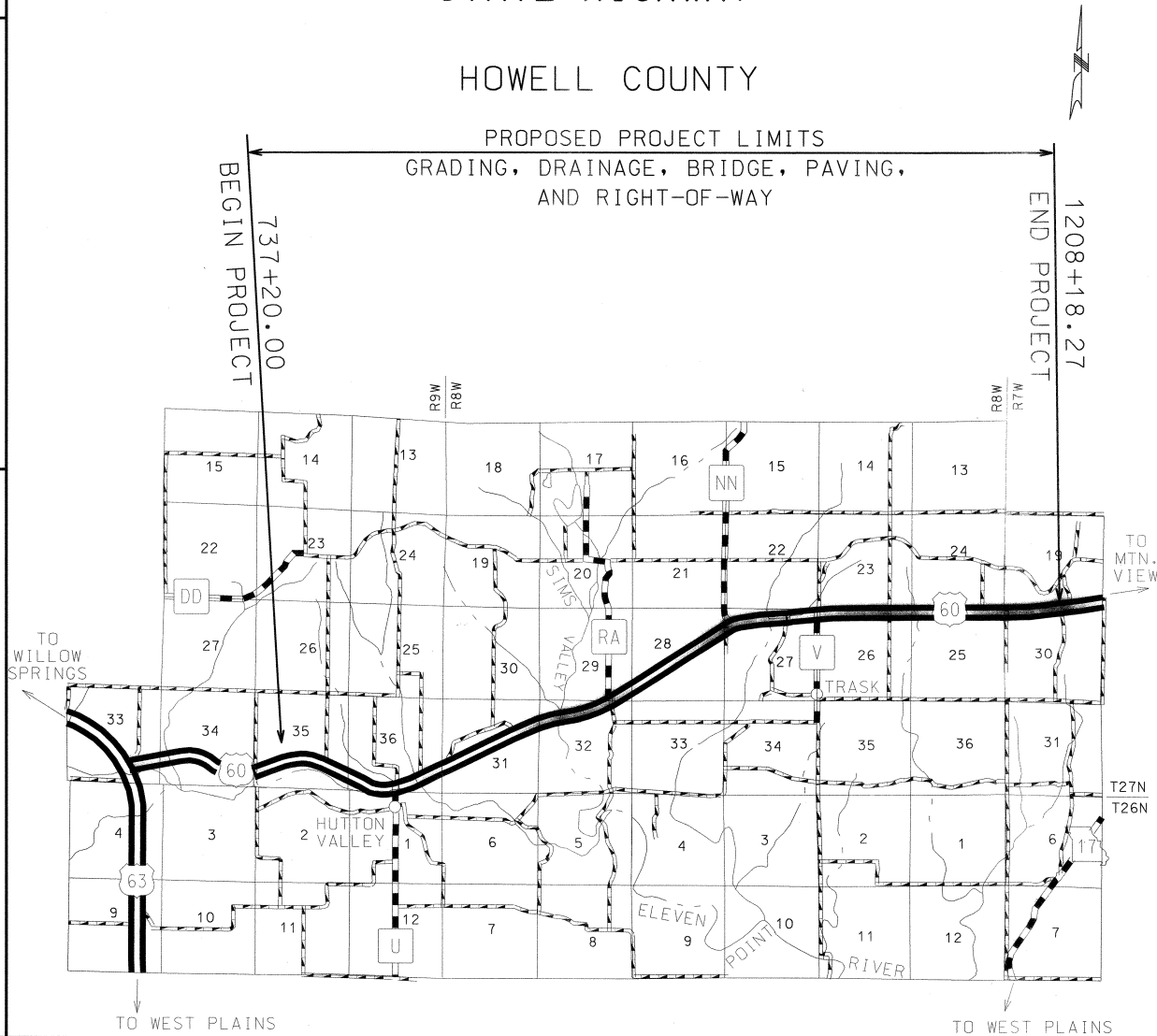

ROUTE 60	STATE MO	DISTRICT 9
JOB NO J9P0364		
CONTRACT ID		
PROJECT NO		
COUNTY HOWELL		

INDEX OF SHEETS

DESCRIPTION	SHEET NUMBER
TITLE SHEET	1
TYPICAL SECTIONS (4 SHEETS)	2
SUMMARY (2 SHEETS)	2-A
SUMMARY (13 SHEETS)	2-B
PLAN-PROFILE	3-19
REFERENCE POINTS	20
COORDINATE POINTS	21-22
SPECIAL SHEETS	23-28
TRAFFIC CONTROL SHEETS	29-38
EROSION CONTROL	39-47
LIGHTING	-
SIGNALS	-
SIGNING	-
PAVEMENT MARKING	48-49
CULVERT SECTIONS	50-76
BRIDGE DRAWINGS	81-884
CROSS SECTIONS	1-186
COMPUTER DATA	-

LENGTH OF PROJECT

BEGINNING OF PROJECT	STA. 737+20.00
END OF PROJECT	STA. 1208+18.27
APPARENT LENGTH	47098.27 FEET
NET LENGTH OF PROJECT	47098.27 FEET
STATE LENGTH	8.920 MILES



DATE NOV 1 6 2006

Contract ID: 070126-902

ROUTE 60	STATE MO	DISTRICT 9	SHEET NO. 2
JOB NO. J9P0364			
CONTRACT ID.			
PROJECT NO.			
COUNTY HOWELL			
			DATE DEC 14 2008

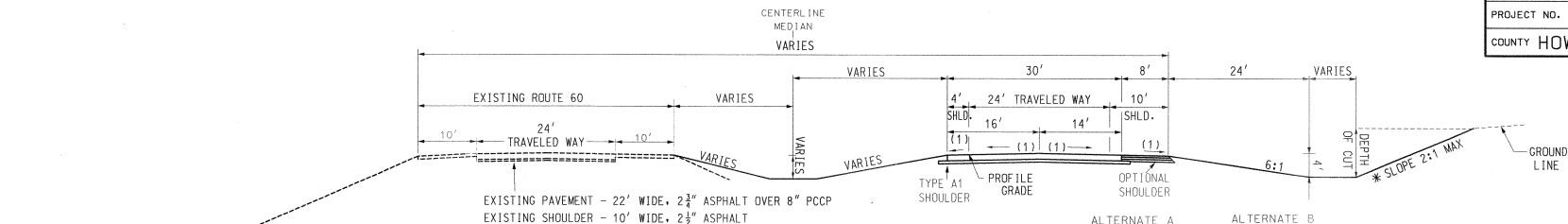

SECTION ON TANGENT

TYPICAL SECTION ROUTE 60
 STA. 737+20.00 TO STA. 743+60.42
 STA. 771+48.95 TO STA. 795+28.59
 STA. 832+98.63 TO STA. 885+74.55
 STA. 914+33.81 TO STA. 917+28.89
 STA. 952+01 TO STA. 1020+41.66

ALTERNATE A
 9" PCCP
 4" TYPE 5 AGG.

ALTERNATE B
 1 1/2" SP 125C (PG 70-22)
 3" SP 250 C (PG 70-22)
 8 1/2" SP 250 C (PG 64-22)
 4" TYPE 5 AGG.

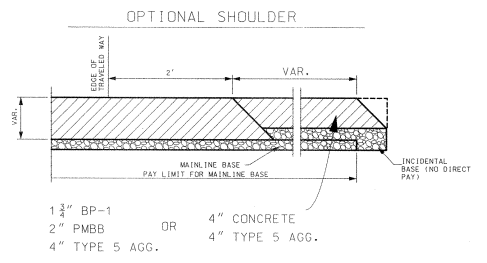

NOTE: FOR 4" CONCRETE SHOULDER OPTION, USE 7.5' JOINT SPACING MATCHING EVERY OTHER JOINT TO THE JOINT IN THE MAINLINE PAVEMENT. 1/3 JOINT MAY BE HAND TOoled OR SAWN. SAW CUT JOINTS IN THE SHOULDER SHALL NOT BE OVERSAWN INTO THE MAINLINE PAVEMENT.

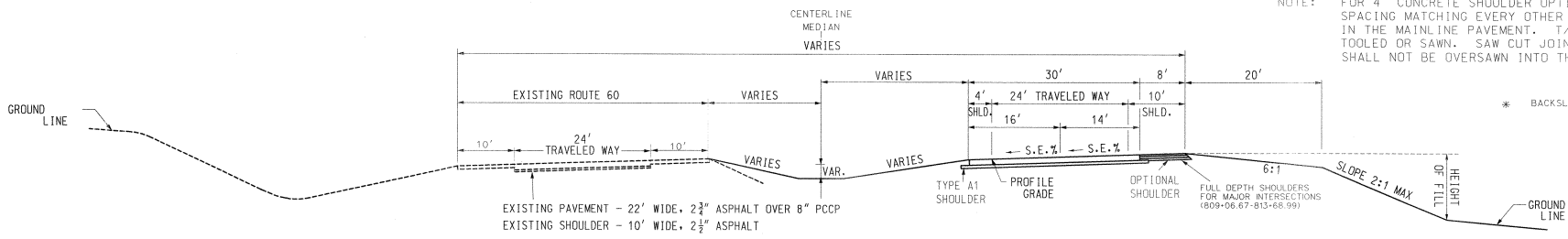

SECTION ON SUPERELEVATED CURVE

TYPICAL SECTION ROUTE 60
 STA. 743+60.42 TO STA. 771+48.95
 STA. 795+28.59 TO STA. 832+98.63
 STA. 885+74.55 TO STA. 914+33.81
 STA. 917+28.89 TO STA. 952+01

ALTERNATE A
 9" PCCP
 4" TYPE 5 AGG.

ALTERNATE B
 1 1/2" SP 125C (PG 70-22)
 3" SP 250 C (PG 70-22)
 8 1/2" SP 250 C (PG 64-22)
 4" TYPE 5 AGG.

MISSOURI HIGHWAYS AND TRANSPORTATION COMMISSION

SUMMARY OF QUANTITIES

ROUTE 60	STATE MO	DISTRICT 9	SHEET NO. 2B	 DATE DEC 14 2008
JOB NO. J9P0364				
CONTRACT ID.				
PROJECT NO.				
COUNTY HOWELL				

SHEET 3 OF 13

GUARDRAIL							
STA.	STA.	LOC.	TYPE A CRASHWORTHY END TERMINAL	BRIDGE ANCHOR SECTION	TYPE A GUARDRAIL	TRANS. SECTION	REMARKS
			EACH	EACH	FT.	FT.	
910+48	914+13	EBL - LT.	1	1	300	1	WEST END BR A7374
911+10	913+99	EBL - RT.		1	300	1	WEST END BR A7374
TOTALS:			1	2	600	2	

PIPE CULVERT HEADWALL - TYPE S							
STA.	LOC.	STD.	LENGTH	SIZE	CLASS B-1 CONC. CY	REINF. STEEL LBS.	CLASS 3 EXC. CY
944+52	6.2' RT.	604.05	11'0"	15"	1.8	80	4
945+20	7.6' RT.	604.05	11'0"	15"	1.8	80	5
1131+65	8.1' RT.	604.05	12'6"	18"	2.2	90	1
1132+01	5.6' RT.	604.05	15'6"	24"	3	110	6
1169+34	3.6' LT.	604.05	11'0"	15"	1.8	80	3
1170+16	1.4' LT.	604.05	11'0"	15"	1.8	80	4
TOTAL:					12.4	520	23

OPTIONAL SHOULDER			
STA.	STA.	LOC.	OPTIONAL SHOULDER SY
737+20	809+06.67	EBL	6388.2
813+69	913+53.19	EBL	8874.8
916+29.34	917+89.34	EBL	71.1
917+89.34	1043+12.96	EBL	11132.1
1020+41	1024+86.06	WBL	395.6
1029+50.86	1208+18.27	WBL	15882.1
TOTALS:			42,744.0

CONCRETE APPROACH PAVEMENT			
STA.	STA.	LOC.	APPROACH PAVEMENT SY
913+53.19	913+90.11	WEST END	155.9
915+92.43	916+29.34	EAST END	155.9
TOTALS:			311.8

PAVEMENT AND BASE (ALTERNATE A)					
STA.	STA.	LOC.	9" N.R. PCCP 15' JOINTS SY	4" TYPE 5 BASE SY	REMARKS
737+20	809+06.67	EBL	23955.6	30344	
809+07	813+68.99	EBL	1952.0	1952	INCLUDES FULL DEPTH SHLDR AT INTERSECTION
813+69	913+53.19	EBL	33280.7	42156	
916+29.34	917+89.34	EBL	604.4	676	INCLUDES FULL DEPTH SHLDR AT BR. END
917+89.34	1043+12.96	EBL	41745.4	52878	
1020+41	1024+86.06	WBL	1483.5	1879	
1024+86.06	1029+50.86	WBL	1962.5	1962	INCLUDES FULL DEPTH SHLDR AT INTERSECTION
1029+50.86	1208+18.27	WBL	59558.0	75440	
769+24			1073.9	1074	MEDIAN OPENING
812+57.00			1494.0	1494	MEDIAN OPENING
845+49.00			1069.7	1070	MEDIAN OPENING
889+52			1083.6	1084	MEDIAN OPENING
944+86			1429.5	1430	MEDIAN OPENING
1025+93			1131.8	1132	MEDIAN OPENING
1076+40			1420.1	1420	MEDIAN OPENING
1116+27			1343.7	1344	MEDIAN OPENING
1169+71			1140.7	1141	MEDIAN OPENING
TOTALS:			175,729.2	218,473	

PAVEMENT AND BASE (ALTERNATE B)					
STA.	STA.	LOC.	13" SUPERPAVE SY	4" TYPE 5 BASE SY	REMARKS
737+20	809+06.67	EBL	23956	30344	
809+07	813+68.99	EBL	1952	1952	INCLUDES FULL DEPTH SHLDR AT INTERSECTION
813+69	913+53.19	EBL	33281	42156	
916+29.34	917+89.34	EBL	604	676	INCLUDES FULL DEPTH SHLDR AT BR. END
917+89.34	1043+12.96	EBL	41745	52878	
1020+41	1024+86.06	WBL	1484	1879	
1024+86.06	1029+50.86	WBL	1962	1962	INCLUDES FULL DEPTH SHLDR AT INTERSECTION
1029+50.86	1208+18.27	WBL	59558	75440	
769+24			1073.9	1074	MEDIAN OPENING
812+57.00			1494.0	1494	MEDIAN OPENING
845+49.00			1069.7	1070	MEDIAN OPENING
889+52			1083.6	1084	MEDIAN OPENING
944+86			1429.5	1430	MEDIAN OPENING
1025+93			1131.8	1132	MEDIAN OPENING
1076+40			1420.1	1420	MEDIAN OPENING
1116+27			1343.7	1344	MEDIAN OPENING
1169+71			1140.7	1141	MEDIAN OPENING
TOTALS:			175,729.2	218,473	

OPTIONAL PAVEMENT (TEMPORARY CROSSOVERS)				
STA.	STA.	OPTIONAL PAVEMENT SY	4" TYPE 1 AGGR. SY	REMARKS
1006+99	1015+59		1100	TEMP. CROSSOVER #2
1024+96	1040+75		1300	TEMP. CROSSOVER #3
1053+55	1062+19.11		1070	TEMP. CROSSOVER #4
TOTALS:			3,469.6	3,470

OPTIONAL PAVEMENT (ROUTE U)				
STA.	STA.	OPTIONAL PAVEMENT SY	4" TYPE 1 AGGR. SY	REMARKS
812+57			679	ROUTE U
TOTALS:			678.6	679

OPTIONAL PAVEMENT (ROUTE NN)				
STA.	STA.	OPTIONAL PAVEMENT SY	4" TYPE 1 AGGR. SY	REMARKS
1025+93			1617	ROUTE NN
TOTALS:			1616.6	1617