

### 616.8.31a (TA-31a) Lane Closure on Alternate Passing Lanes - MT

SPEED	SIGN SPACING (ft.)		TAPER LENGTH (ft.)		OPTIONAL BUFFER LENGTH (ft.) (B)	CHANNELIZER SPACING (ft.)	
	Undivided (S)	Divided (S)	Shoulder (1) (T1)	Lane (2) (T2)		Tapers	Buffer/ Work Areas
0-35	200	-	70	245	250	35	50
40-45	350	-	150	540	360	40	100
50-55	500	-	185	660	495	50	100
60-70	SA - 1000, SB - 1500, and SC - 2640		235	840	730	60	100

1 Shoulder taper length based on 10 ft. (standard shoulder width) offset. 2 Lane taper length based on 12 ft. (standard lane width) offset.

TYPE OF ROADWAY	SIGN HEIGHT	MAXIMUM WORK ZONE LENGTH (L)
URBAN	1' Portable 7' Post	1 Mi.
RURAL UNDIVIDED	1' Portable 5' Post	3 Mi.

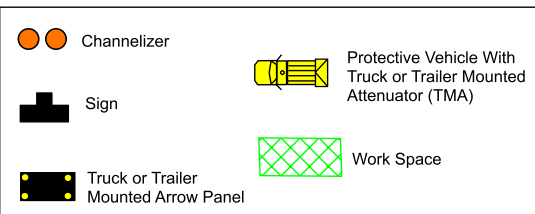

**NOTES:**

Except as noted below, a protective vehicle **shall** be used while work is in progress. The protective vehicle **shall** be equipped with a TMA and flashing arrow panel and positioned at least 150 ft. in advance of the work space. The protective vehicle **may** be eliminated if the roadway is posted at 45 mph or below, the work vehicle is positioned in advance of the work space, and the work vehicle uses activated rotating lights or strobe lights.

Additional warning signs **shall** be erected at each intersection with another state highway within the work zone. Upon the discretion of the supervisor, additional warning signs **may** be erected at other intersections within the work zone.

For short duration operations, signs, and channelizers **may** be reduced or eliminated.

For mobile operations where workers are on foot and move with the operation, channelizers **may** be reduced or eliminated.

For one or two-lane mobile operations, refer to **EPG 616.8.17 (TA-17) Mobile Operation on Two-Lane Highways** to determine if a protective vehicle is required. When used, the protective vehicle **shall** be used when work is in progress. The protective vehicle **shall** be equipped with a vehicle mounted sign and **shall** be equipped with a TMA and flashing arrow panel.

